

# Revelite® AL Low Profile

## Installation Instructions

cerno®

### General Product information

This product is suitable for indoor dry locations only.

THIS IS A LOW VOLTAGE (24VDC) FIXTURE AND MUST BE USED WITH THE SUPPLIED OR MANUFACTURER APPROVED POWER SUPPLY

This fixture can be controlled by a remote 0-10V low voltage dimmer. Please see the next page for more information.



### CAUTION - RISK OF FIRE

This product requires installation by a qualified electrician. Before installing be sure to read all instructions and **TURN POWER OFF TO THE JUNCTION BOX**

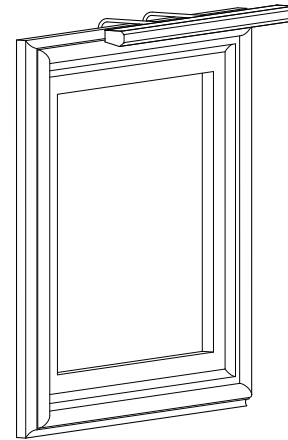

US Patent # 7,070,293 and 9,134,004.  
Other US and International Patents Pending

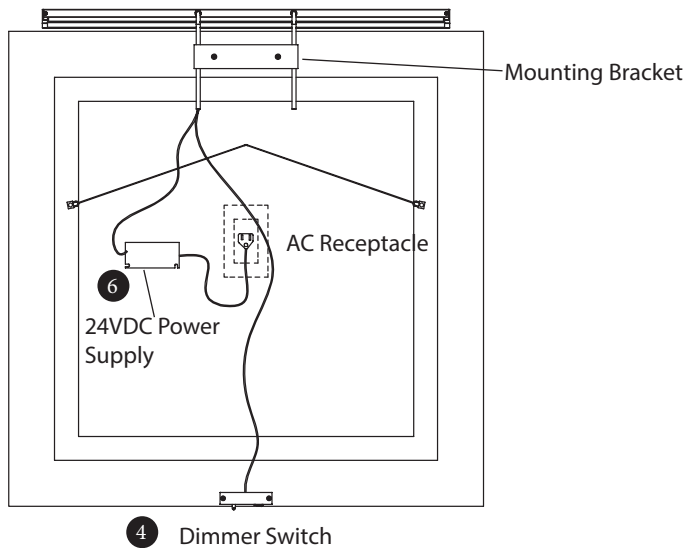

### Installing the Mounting Bracket

- 1 Attach the plastic mounting bracket and reinforcement bracket to the back of the frame using the supplied #8 panhead screws.
- 2 If necessary, use the included spacers to ensure that when the mounting arms are slid into the bracket, they will be clear of any obstructions on the back of the frame and canvas.
- 3 Alternatively, if desired, the mounting bracket can be attached to the wall behind the artwork.

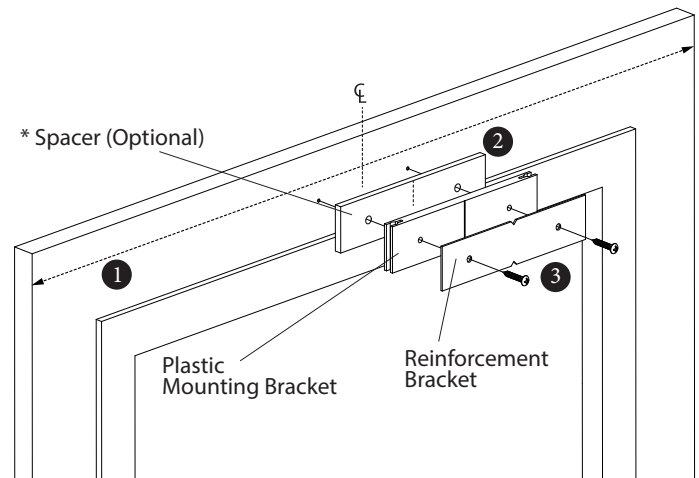

### Installing the Dimmer Switch

- 4 The included dimmer switch can be used to turn the fixture on and off, as well as dim the fixture. It can be mounted wherever you prefer, however we recommend mounting it to the back of the frame, either on the bottom as shown, or on the side.
- 5 Attach the switch using the included #6 flathead screws or adhesive patches.

If you would like to use a remote dimmer or control system, see the section later in these instructions.

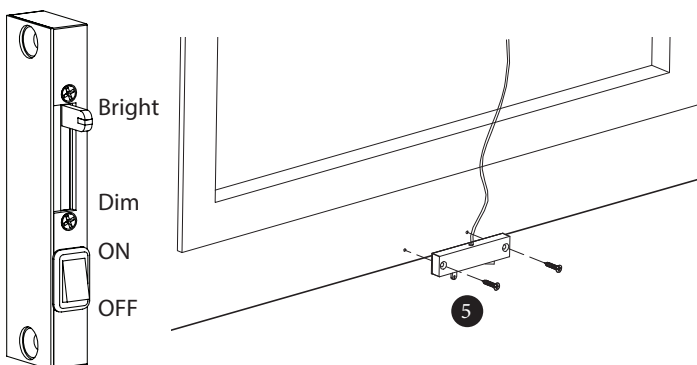

### Installing the Power Supply

- 6 The Revelite AL is a low voltage fixture. It requires a 24Volt DC input. The included plug in power supply can be mounted to the wall behind the painting, attached to the back of the frame, or installed remotely.

### WARNING

CONNECTING THE FIXTURE DIRECTLY TO LINE VOLTAGE WILL DESTROY IT AND VOID THE WARRANTY!

MAKE SURE THAT THE RED WIRE IS CONNECTED TO THE POSITIVE (+) LEAD ON THE POWER SUPPLY, AND THE BLACK WIRE IS CONNECTED TO THE NEGATIVE (-) or GROUND LEAD ON THE POWER SUPPLY.

### Attaching the Fixture to the Mounting Bracket

- 7 Attach the fixture to the mounting bracket by sliding the arms vertically into the mounting bracket. Do not snap the mounting arms into sides!
- 8 Adjust the height of the fixture and level it by sliding the mounting arms up or down in the slots in the mounting bracket. The bottom of the fixture should be about 4 inches above the top edge of the canvas.

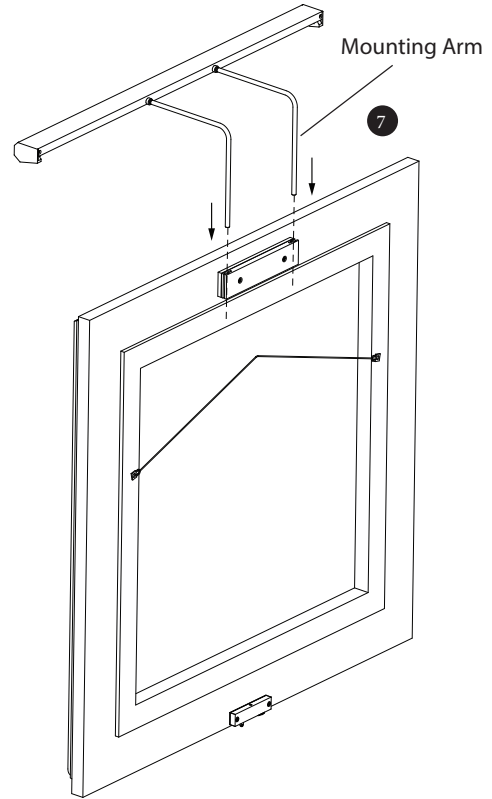
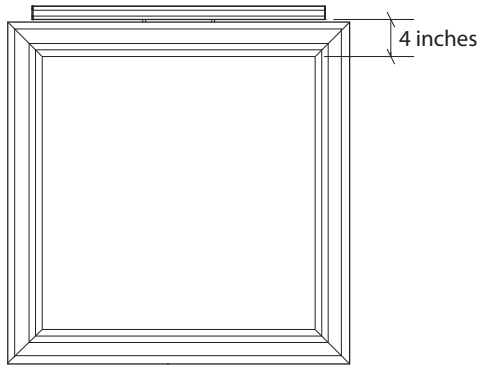

### Attaching the Fixture to a Remote Dimmer or Control System

The Revelite AL can be controlled by connecting the purple and grey wires to a dimmer or control system that uses the industry standard 0-10V dimming interface. More than one Revelite AL fixture can be attached to the same dimmer. Dimmers should be installed by a licensed electrician and in accordance with the manufacturer's instructions.

**Hardwire Wiring Diagram Using a Remote 0-10V Dimmer Switch or Control System**

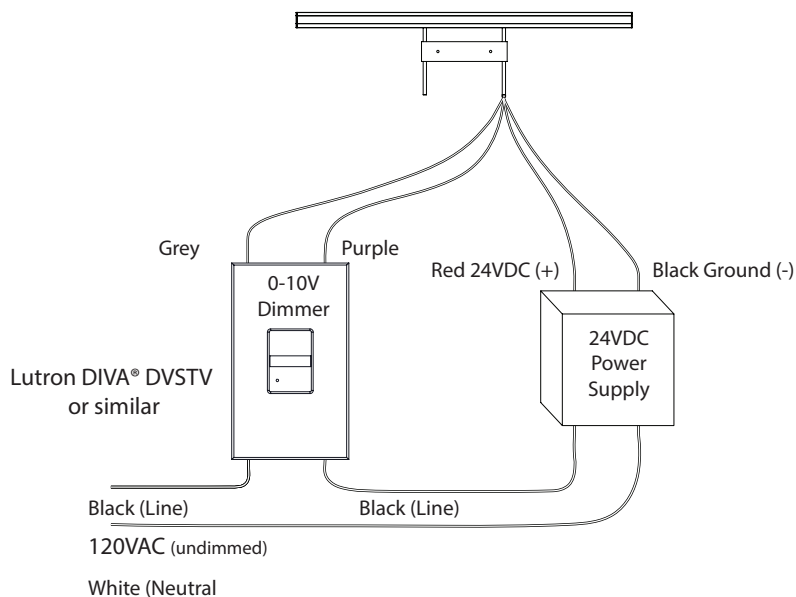

**Hardwire Wiring Diagram Using the Included Dimmer Switch**

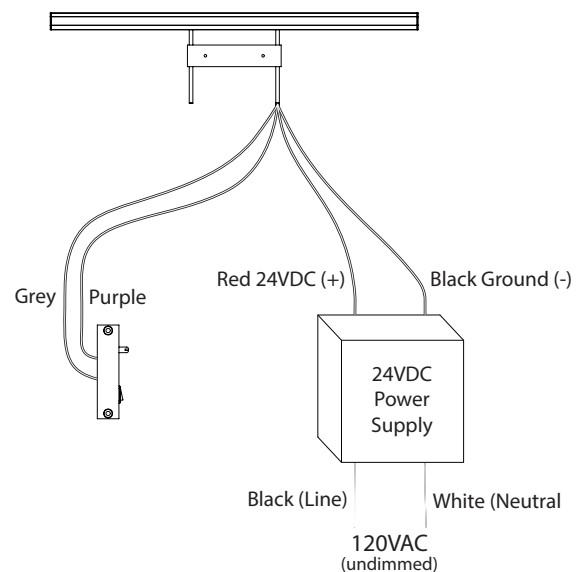

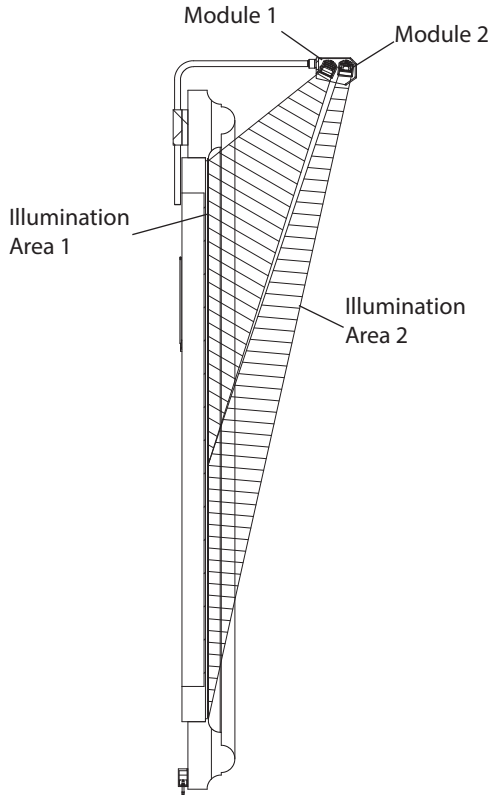

### Adjusting the Light Output

Every Revelite AL is custom tuned to illuminate the size of the canvas specified at the time of purchase. The following adjustments should not need to be made unless the fixture is moved to a different size canvas, or you would like to further tune the light output once it is mounted to the actual piece of art.

The Revelite AL consists of independently tilt-able and aim-able rows of LEDs, or "modules". The Revelite AL1 has one module, and the Revelite AL2 has two. Module 1 is closest to the artwork and illuminates the upper area of the canvas, Module 2 is farther from the artwork and illuminates the lower area of the canvas.

- 9 The brightness of each module is adjusted by turning the small phillips head screw located at the right side of the fixture when you are facing it. The screw should turn with very little resistance. Using too much force may damage delicate electronic components. Once the brightness has been adjusted for each module, the brightness balance between the two modules will stay the same when the fixture is dimmed using the included dimmer or a remote dimmer.
- 10 To tilt, or aim each module, loosen the locking screws at each end of the module, tilt the module to the desired position, and then tighten the locking screws.

A #1 phillips screwdriver and a 5/64" allen key have been included in the hardware lot.

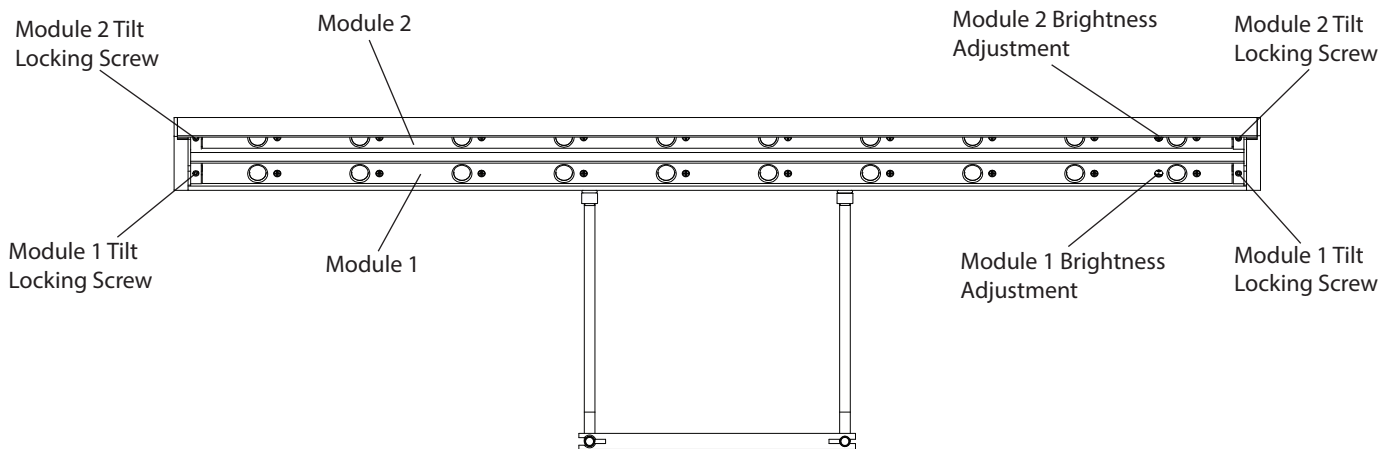

### Recommended Adjustment Procedure

The following procedure is recommended for adjusting your Revelite AL:

1. Turn the brightness of module 1 all the way down and the brightness of module 2 all the way up.
2. Adjust the tilt of module 2 until it covers the bottom two thirds of the canvas.
3. Turn the brightness up on module 1 and adjust the tilt until the top of the canvas is illuminated. Fine tune the brightness of module 1 until vertical uniformity is achieved.
4. Adjust the overall brightness using the dimmer switch.

